

PDH2515-Series

Inductance Range: 1.0μH~10μH
Temperature Range: -40℃~+125℃

DIMENSIONS(mm)

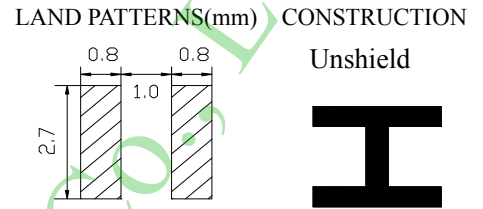
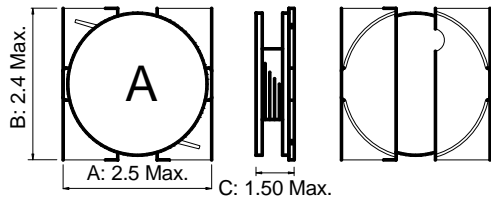

FEATURES:

- ★Quantity / Reel: 4000pcs
- ★Small products, Quadrate 2.4mm*2.5mm Max, Height 1.5mm Type.
- ★The use of carrier tape package for SMT reflow soldering process
- ★Widely use in DC-DC converter/LCD TV/Notebook/
PDA/MP3 & MP4 player/Digital camera/DVD etc.
- ★Design to customer requirement

RoHS Compliant(SGS Certified Result)				
Pb	Cd	Cr+6	PBBs	PBDEs
<1000ppm	ND	ND	ND	ND

Electrical Characteristics:

Part Number	Test Condition	Inductance (μH)	Tolerance (%)	D.C.R(mΩ) Max.	Isat1(A) @L-Drop10% (Max.)	Isat2(A) @L-Drop35% (Max.)	I rms(A) @ΔT=40℃(Max.)
PDH2515-1R0M	100KHz/0.1V	1.0	±20	89	2.33	2.75	1.52
PDH2515-1R5M	100KHz/0.1V	1.5	±20	115	2.16	2.33	1.44
PDH2515-2R2M	100KHz/0.1V	2.2	±20	168	1.75	1.88	1.08
PDH2515-3R3M	100KHz/0.1V	3.3	±20	254	1.40	1.54	0.88
PDH2515-4R7M	100KHz/0.1V	4.7	±20	298	1.20	1.30	0.84
PDH2515-5R6M	100KHz/0.1V	5.6	±20	408	1.08	1.20	0.68
PDH2515-6R8M	100KHz/0.1V	6.8	±20	556	0.95	1.04	0.60
PDH2515-8R2M	100KHz/0.1V	8.2	±20	593	0.85	0.96	0.56
PDH2515-100M	100KHz/0.1V	10	±20	676	0.79	0.92	0.55

- 1、 Inductance is measured with a LCR meter:HP4284A & 3532-50 or equivalent.
- 2、 D.C .R is measured with a Digital Multimeter TH2512B or equivalent.
- 3、 The Isat1 is the current at which the inductance decreases by 10% from the initial value
- 4、 The Isat2 is the current at which the inductance decreases by 35% from the initial value
- 5、 The Irms by Stand-Type is the current at which the temperature rise is ΔT≤40℃, whichever (Ta=20℃)